

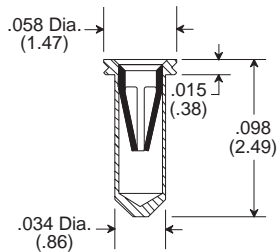

Contact Acceptance Range .016" (.41mm) - .022" (.56mm) Dia. or .010" (.25mm) x .018" (.46mm) Rectangular Lead

Type	Part Number	Contact Group
-491	4427	A

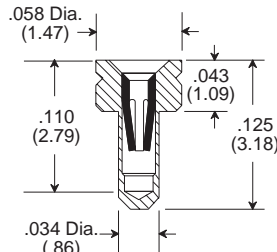
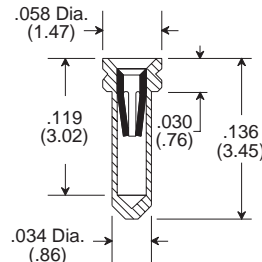

Type	Part Number	Contact Group
-246	3257	A



Type	Part Number	Contact Group
-294	3784	A

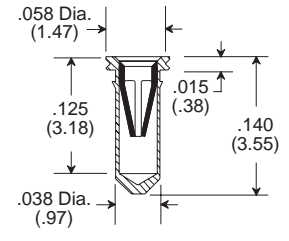

Type	Part Number	Contact Group
-517	4520	A

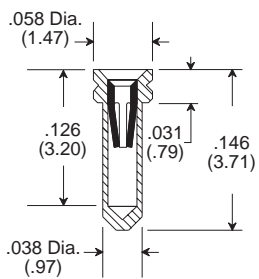

Type	Part Number	Contact Group
-290	3708	A

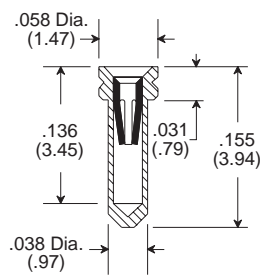

Type	Part Number	Contact Group
-85	1371	A

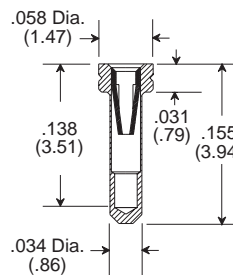

Type	Part Number	Contact Group
-176	2239	A

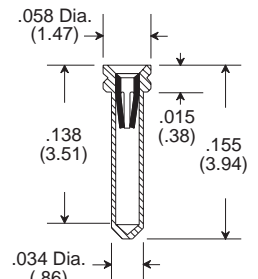

Type	Part Number	Contact Group
-210	2887	A

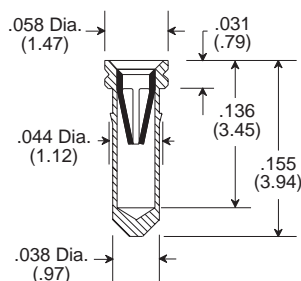

Type	Part Number	Contact Group
-350	4041	A

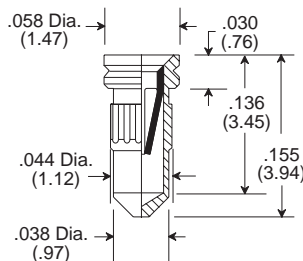

Type	Part Number	Contact Group
-69	1401	A

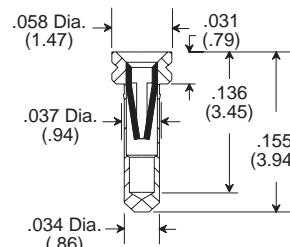

Type	Part Number	Contact Group
-428	4316	A

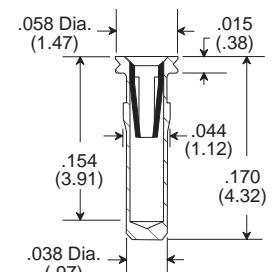

Type	Part Number	Contact Group
-588	4804	A

Material:
Terminal: Brass - Copper Alloy (C36000), ASTM-B-16
Contact: Beryllium Copper - Copper Alloy (C17200), ASTM-B-194

Plating:
Contact: G = Gold/Nickel
T = Tin-Lead/Nickel

Gold: per MIL-G-45204
Tin-Lead: per MIL-P-81728
Nickel: per QQ-N-290

Note: Pins with "V" groove in head may be supplied in Peel-A-Way®

Terminals not drawn to scale.